

Mayor Street Traffic Diversions and Construction Works

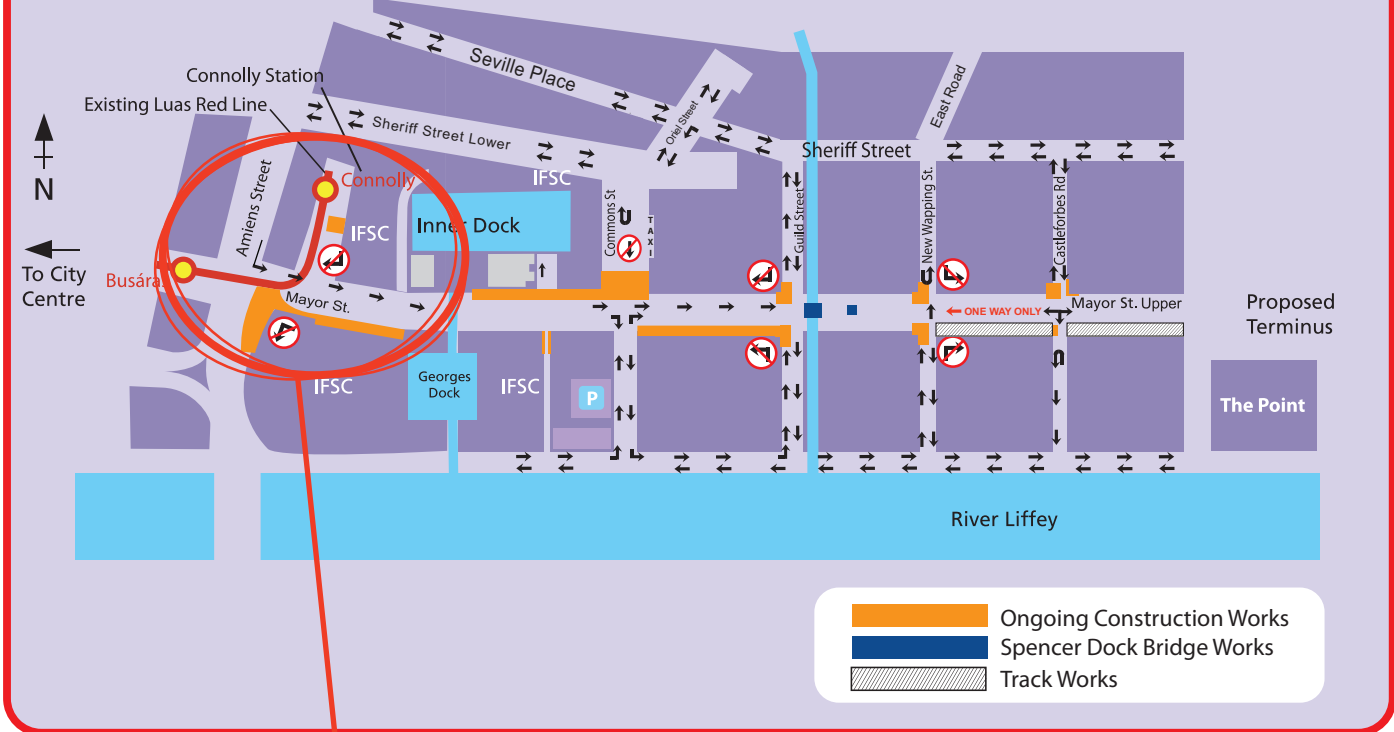

UTILITY DIVERSIONS

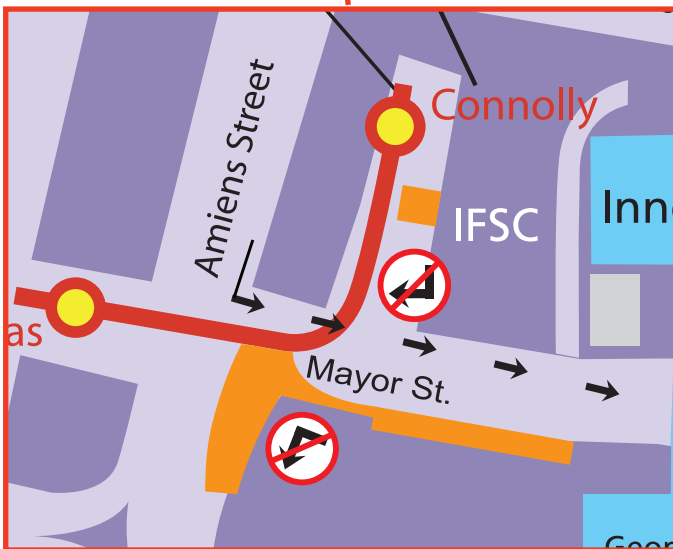

CONTRACT MILESTONES - SWITCH OVERS

The Utilities Diversions Contract executed by our contractor, SIAC, on behalf of the Railway Procurement Agency has reached a significant milestone. We have reached the stage where we are nearly ready for the utilities companies and the local authorities to switch over from their old systems and networks to the newly installed water and drainage systems and new, capacity enhanced cabling networks.

A very important work to be executed by the local authorities in the area **from Amiens Street to Guild Street, between end of May and mid June**, is the switching water supplies from the existing system to the new system. The works will be carried out by the Dublin City Council and will involve temporary disconnection of water supplies into buildings. We will be working with the Council to give pre-notice of 1 week to the general area. The Water Services Division on behalf of the council will then confirm any temporary shut-offs with the affected buildings 24 hours prior to the main water supply shut offs.

MAYOR STREET LOWER

La Touche House- Amiens Street - ONE WAY SYSTEM

The left-hand filter lane from Harbour Master Place out onto Amiens Street was temporarily closed on 28th April. This closure was delayed in order to minimise the disruption for local residents and businesses whilst we carry out diversions in this area. Works are planned to continue in this area for 6 weeks.

Between La Touche House and CHQ Building

Utility and drainage works in front of O'Briens, The Laundry and Dry Cleaning Shop and Munchies will continue and are due to be completed by mid May. In the interest of health and safety, we ask pedestrians to observe the signs and to follow the signposted route.

Outside George's Dock 2 to George's Dock 6

Works are ongoing in front of George's Dock nos. 2 to 6. These works will link up the new utility networks already installed between George's Dock bridge and Commons Street, in preparation for utility switchovers.

Exchange Place

The bulk of the works at the entrance of Exchange Place has been completed. There will be some minor localised excavations in this area in the near future. We would like to thank Jury's Inn on Custom House Quay for their kind assistance during the works in Exchange Place.

Commons Street Junction

The works on the northern side of the junction will continue until the end of June 2008. All traffic coming from North Wall Quay onto Commons Street is diverted via a right turn onto Mayor Street Lower towards Guild Street. Through traffic along Mayor Street coming from Amiens Street via George's Dock Bridge is maintained.

Between Commons Street and Guild Street

Works on the southern side of the road are progressing well. The one-way system will remain in operation, with traffic continuing to flow eastwards towards Guild Street. Works at Guild Street junction continue. Some localised excavations are required in the footpath to allow for switchover works to the new utility network.

Many areas will be reinstated as we near the completion of the utility works, during the coming months. All retailers and shops remain accessible via diversion routes and are open for business during the works. We ask all road users to adhere to the traffic signs.

Alderman Way

The final phase of drainage works at the entrances to Alderman Way has commenced with utility works being undertaken in tandem where possible. In the interest of health and safety, we ask road users to observe the yield signs when entering or exiting Alderman Way and to pay attention to pedestrian movements.

MAYOR STREET UPPER

Utilities Works between the junctions of New Wapping Street and Castleforbes Road on Mayor Street Upper have been completed and we will be starting the installation of track-bed this month. Traffic flows in the area will remain the same until further notice.

New Wapping Street - Mayor Street Upper Junction

Heading from the Quays into New Wapping Street there will be two-way traffic up to the junction with Mayor Street Upper. Drivers will be able to drive through the junction one way northbound (in the direction of Sheriff Street.) There is no through traffic from Sheriff Street to the Quays.

Castleforbes Road - Mayor Street Upper Junction

Heading from Sheriff Street into Castleforbes Road, there is two-way traffic up to the junction with Mayor Street Upper and there is access only through the junction one way southbound (in the direction of the Quays.) There is no through traffic from the Quays to Sheriff Street.

BRIDGE & UNDERGROUND SUBSTATION WORKS

Spencer Dock Bridge

Works on Spencer Dock Bridge are progressing well. All of the permanent piling for both abutments and centre pier has been completed as well as the sheet piling for the centre cofferdam. Excavation works within the cofferdam are underway and construction of the pile cap will follow. Construction of both the east and west bridge abutments has commenced also.

Spencer Dock Underground Substation in Spencer Dock

A separate power supply substation for the new light rail system is being constructed. The excavation works for this power station has been completed construction of the reinforced concrete base and walls will follow.

TRACK AND CIVIL WORKS

RPA has recently awarded the contract for the installation of the LUAS track-work and related Luas infrastructure to M-Pact, a joint venture between Laing O'Rourke and Grantrail. The track and infrastructure works are due to commence in the Upper Mayor Street area this month.

Brief Description of the Works

These works will involve excavation of the track bed to approximately 1.2 metres below existing road level. The concrete track-bed will be installed in two layers over a bank of service ducts which will carry power and telecoms cables to serve the Luas trams. This phase of the works will involve the installation of tram stops and all related civil and track infrastructure for the Luas Red Line Extension. Footpaths and kerb-lines along the Docklands Line C1 route will be renewed as required.

AMIENS STREET DELTA JUNCTION & ABBEY STREET STOP ENHANCEMENT

One of the major challenges for the project team will be the installation of a new three-way Luas Trackwork system at Amiens Street and Mayor Street. This junction will allow trams coming from Busaras to go to Connolly Stop or to proceed directly towards The Point. It is intended to install the bulk of the new track-work across Amiens Street from late June until the end of August as these are traditionally the periods when traffic volumes are lowest. RPA and the contractors are finalizing discussions with the local authorities to agree the traffic management and diversion routes for this area during these works.

While these works are being carried out it will be necessary to terminate the Luas Red Line trams at Abbey Street Stop. This change is expected to take place from mid June. Works will be carried out this month and in June at the Abbey Street Stop to increase the passenger capacity of Abbey Street Stop. RPA and Veolia are liaising with Dublin City Council, and affected stakeholders to minimise the disruption to customers.



LUAS Docklands (LINE C1)

Construction Phase
Update No.

11

7th May 2008

GENERAL OVERVIEW OF THE CONSTRUCTION WORKS OF LUAS DOCKLANDS - LINE C1

Constructing a Luas Line Extension involves certain steps and phases of construction. The image below explains the different phases of the works. At the moment we are completing the Utilities Diversions and building the bridges while we kick start the track laying contract. We aim to complete the construction of the line by the end of 2009.

OPEN FORUM MEETINGS

Come in for a cup of coffee between 7.30AM and 9.00am in the National College of Ireland on Mayor Square. Our team is happy to meet the residents, commuters and businesses to answer any questions you might have. Our next meetings are coming up on

15/05/08
29/05/08
12/06/08
26/06/08
10/07/08
24/07/08

I SHOP THE LINE

We encourage people to support local trade in the multitude of shops available to them. Details of the shops based along the construction of the new Docklands extension are available on <http://www.rpa.ie/luas/commercial/advertising>.

